

TRIQ L-ISQOF S. GAFFIERO

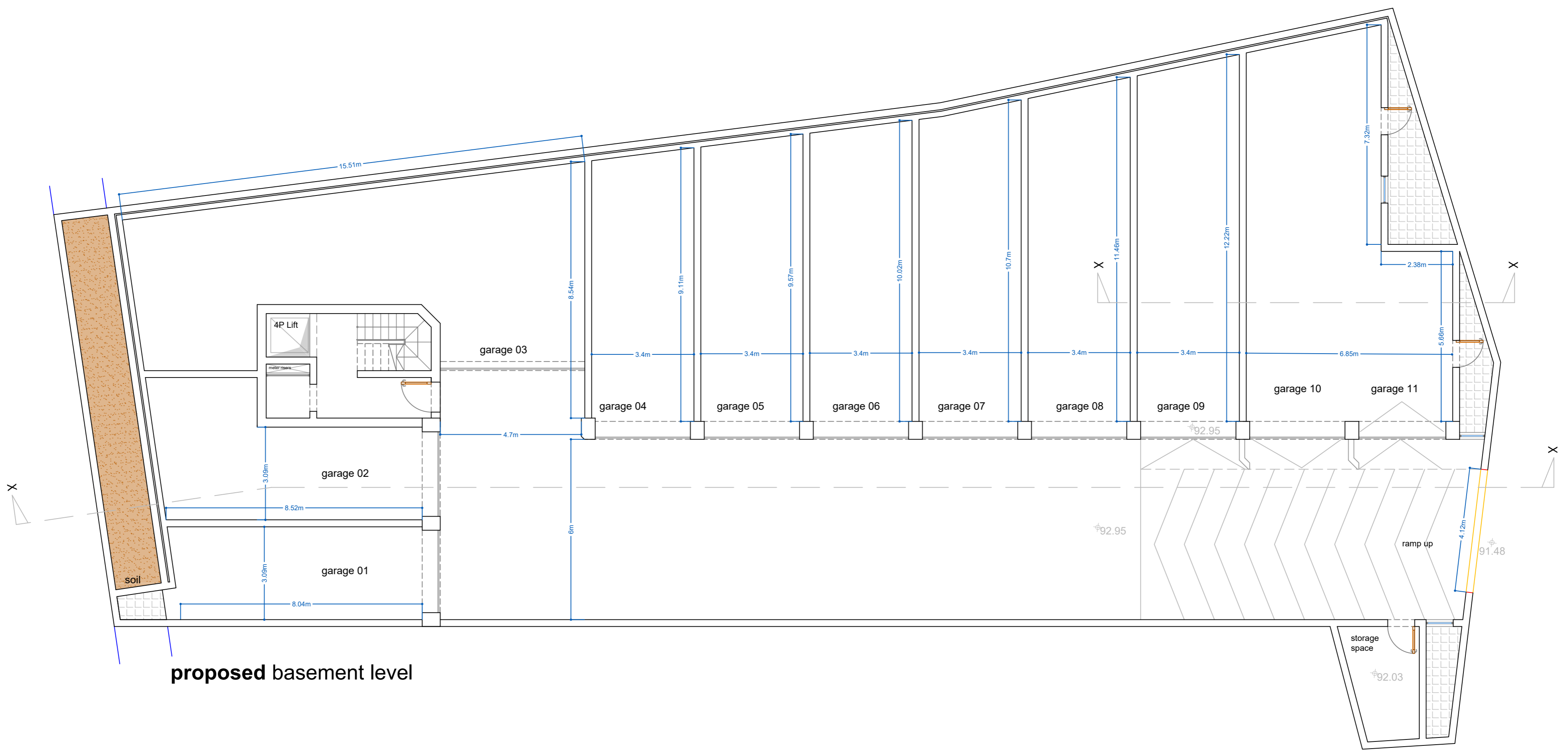

proposed basement level

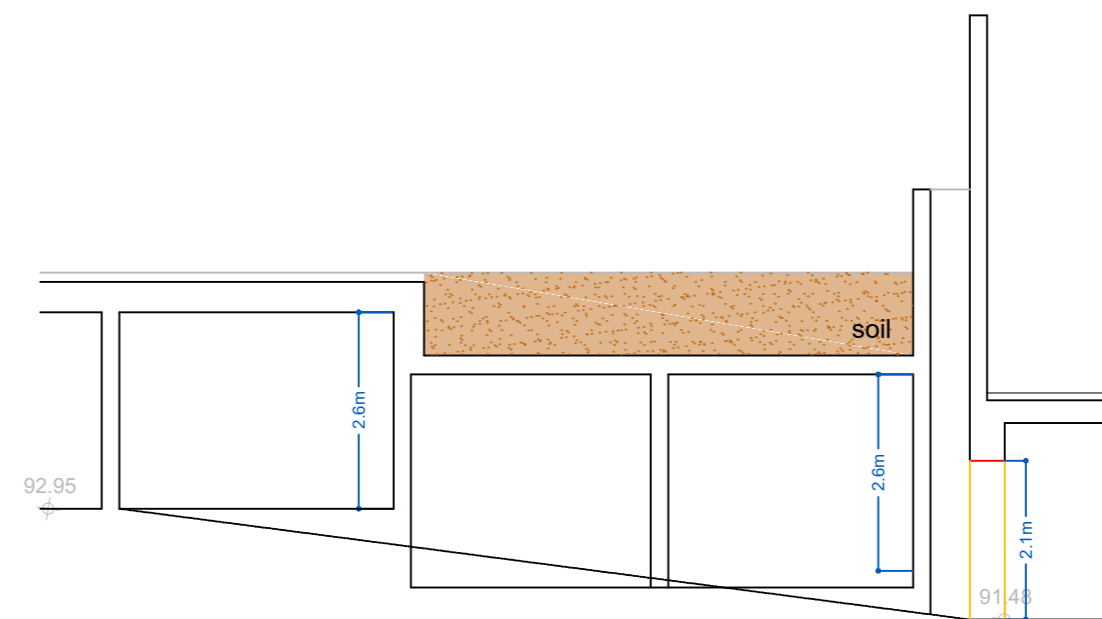

part section x-x through ramp

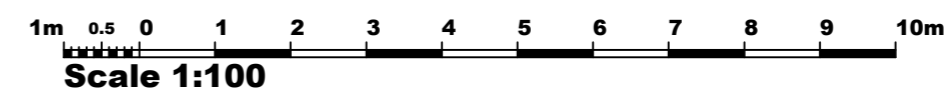

ROBERT ELLUL SCIBERRAS			
ARCHITECT & CIVIL ENGINEER			
Add: 88, Rose Garden, Vjati Ix-carolla, Zurrieq ZRQ 1615			
Mob: +356 99892739			
Email: robertellul@hotmail.com			
Site at Triq L-Isqof S.Gaffiero			Job No.
Proposed Drawings			Drawing No. PR-01
Drawn by SB	Checked by RES	Date April 2019	Scale A2 1:100